



## Mobile Hoists - Moving & Handling



# integrity<sup>®</sup>

HEALTHCARE YOU CAN TRUST



## Integrity Marlin 180E<sup>™</sup> & Marlin Pro 205E<sup>™</sup>

Mobile Hoists

The **Marlin Range** of mobile hoists can support the safe transfer of elderly or disabled people with limited mobility, the hoist design promotes single handed care. This user-friendly hoist reduces the risk and strain to caregivers by offering electric leg opening and a unique foot bar as standard, manufactured from high quality steel with a white powder coating finish ensuring they are easy to clean and are ideal for everyday use.



### FEATURES

### BENEFITS

Strong robust design	Durable powder coated frame, easy to clean, great to recycle
Electric leg opening as standard	Gives the carer greater control when positioning the hoist
Safety features	All hoists come with emergency manual lowering and easy to reach emergency stop button
Foot bar	The unique foot bar not only protects the actuator from accidental damage, it also assists the carer when positioning the hoist
Dual braked rear castors	Makes the hoist easier to manoeuvre and aids in the positioning of the device
Tool free assembly	Allows the hoist to be easily and quickly assembled, great for recycling or transporting
Easy to position	The ergonomically designed handle ensures all carers can easily manoeuvre the hoist regardless of height or stature



MOBILE HOISTS - MOVING & HANDLING



Linak control box with easy to see charging lights. LCD visual diagnostic option also available.



Clear and easy to use 4-way handset, allows you to operate the boom and leg opening with a single touch.



Robust German dual brake castor, make it easier to apply and disengage the castors when in use.



Ergonomically designed handset makes the hoist easy to manoeuvre regardless of the position of the user.



Manual emergency lowering system in case the battery is discharged, allows you to lower a client safely.



Unique foot bar protects the base actuator from accidental damage and also assist the care giver in manoeuvring a heavy load when moving the hoist forward.

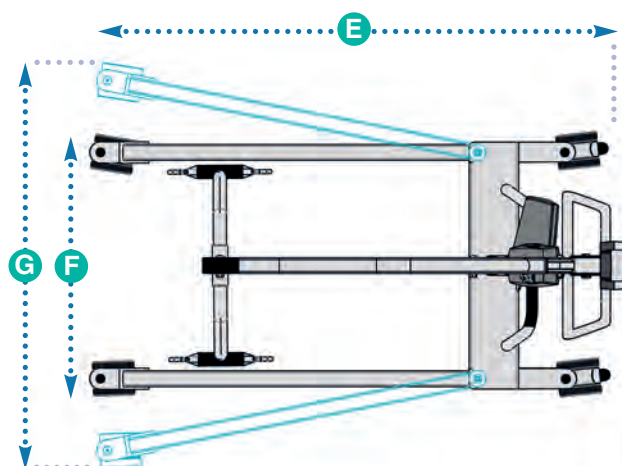
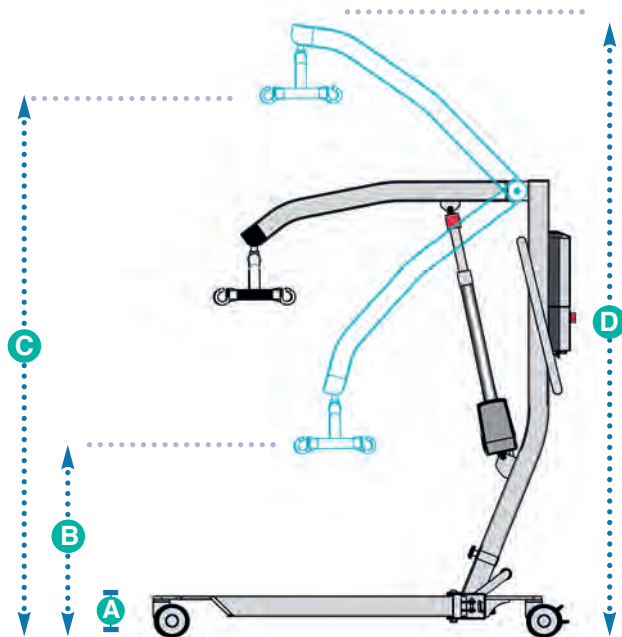

A

B

C

D

E

F

G

100mm

380mm

1750mm

2010mm

1235mm

620mm

1150mm



Our dedicated teams are here to serve your every need through the provision of outstanding customer support via your local representatives. British manufacturing at its very best. Whether you need a specialised mattress and hoists or an entire hospital fit out, we truly have “**healthcare you can trust**”.



#### TECHNICAL INFORMATION

PRODUCT CODE - Marlin 180E -1001-10001 Marlin Pro 205E -1001-10003

Sling Connection	Looped	
Lift	<b>180E</b> - Electric (Linak LA40 - 8kn)	<b>205E</b> - Electric (Linak LA44 - 10kn)
Leg Opening	Electric (Linak LA23 - 2.5kn)	
Handset Controls	Wired Linak electric hook handset	
Control Box	Standard (no screen)	
Duty Cycle	15% use, 85% rest	
Battery	Linak 24 V SLA, 2.9 Ah	
Charging Time	8 hours	
Lifts Per Charge	30	
IP Rating (controls)	IPX4	
IP Rating (battery)	IPX5	
Material	Powder coated steel	
Warranty	5 years (excludes battery which is 1 year)	

If you require any additional information, please telephone **+44 (0)800 043 0050**

Due to our policy of continued development Integrity Healthcare reserve the right to amend any specifications without notice.



Unit 47, Vale Business Park, Cowbridge Vale of Glamorgan CF71 7PF

T: +44 (0)800 043 0050

E: [customerservices@integrity-healthcare.co.uk](mailto:customerservices@integrity-healthcare.co.uk)



[www.integrity-healthcare.co.uk](http://www.integrity-healthcare.co.uk)